

BARKLY HIGHWAY

PICNIC AREA



ENTRANCE

EXIT

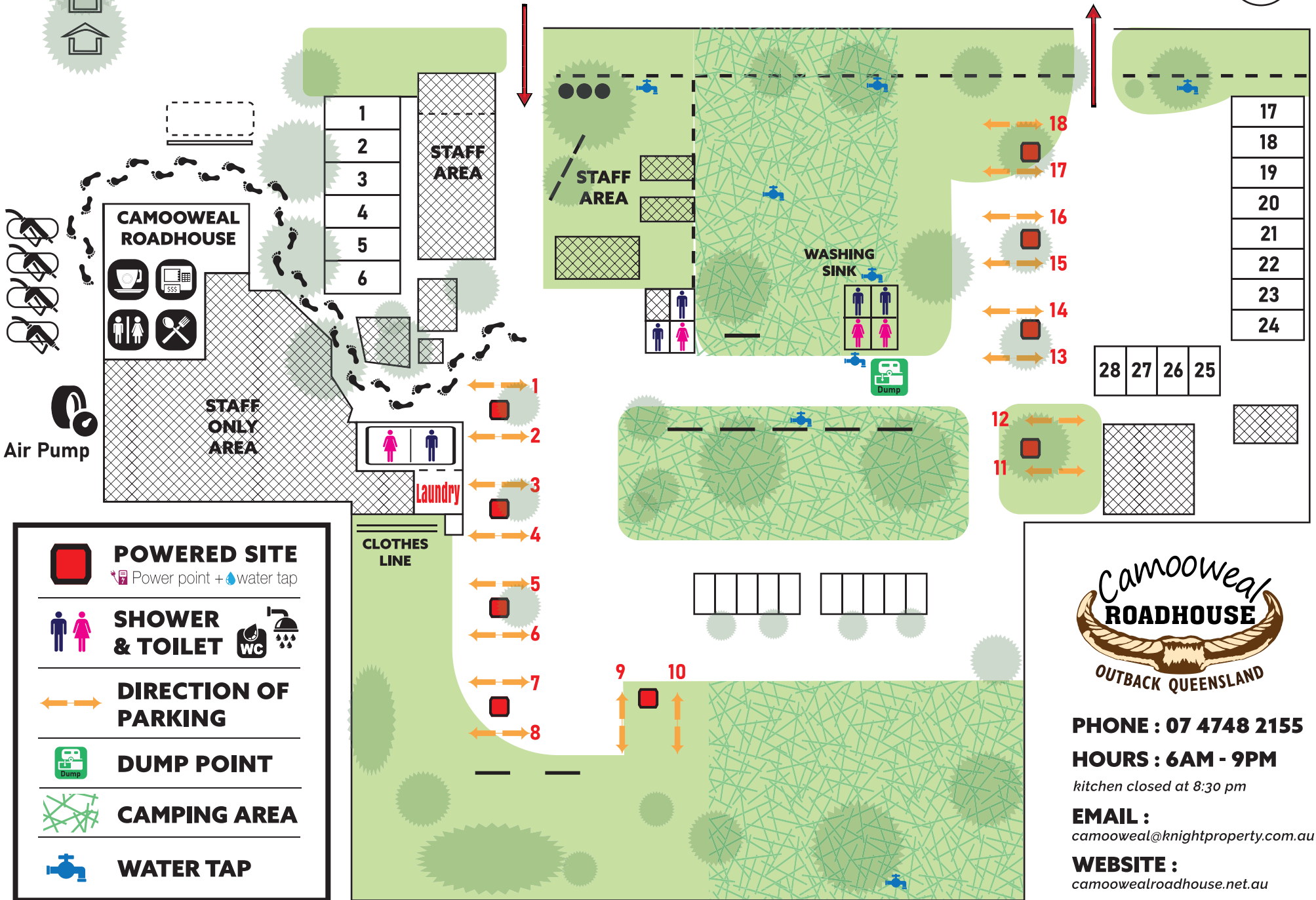

PHONE : 07 4748 2155
HOURS : 6AM - 9PM
kitchen closed at 8:30 pm
EMAIL :
camooweal@knightproperty.com.au
WEBSITE :
camoowealroadhouse.net.au



Caravan Park Information & Policies

We hope you enjoy your stay, please take some time to read this information to understand our caravan park's policies and recommendations.

POWERED SITES

Powered sites are numbered 1 to 18. The numbers are located on the power pole at each site. When parking please ensure your caravan or vehicle does not protrude onto the roadway or another site which would hinder other guests in accessing or leaving the park. The white posts at the front of the sites are a guide.

CAMP SITES (UNPOWERED)

Camp sites are not numbered and guests can access a site in any of the designated areas. Please ensure you do not camp in a powered area if you nominated a non powered campsite.

SPEED LIMIT

A speed limit of **8 kph** applies to all vehicles within the Park. Please adhere to this so as to avoid accidents and dust.

NOISE

Generators are not permitted. Guests are requested to cease any noise which would disturb neighbours in or outside the park by 10 p.m.

PETS

Pets are permitted in the Park area. Animals must be under control at all times. Dogs **MUST** be on a leash whilst in the Park. Guests are also required to **clean up** any mess made by their animals both in the park and on the adjacent footpath. Only registered service dogs (Guide Dogs etc.) are permitted in Common areas however no washing of pets or pet bedding is permitted in Washing machines or sinks.

WI-FI

A free wifi service is available to guests within the park. Please contact staff for information re logging in to the portal and the password required.

VACATING

Guests are asked to vacate the park by **10 a.m.** on the day of departure. If you are unable to do this please speak to a staff member (Park or Roadhouse) and advise of the reason and approximate departure time. We need to be able to ensure that sites are available for people who have booked and are due to arrive in the Park.

LAUNDRY FACILITIES

There is a laundry with Washing Machines and Dryer located in the main toilet block of the Park for your convenience. Each machine takes 5 * \$1 coins to operate. There is also a clothesline adjacent to the laundry on the Eastern side of the building. Guests are asked to remove their washing from the machines as quickly as possible to avoid unnecessary delays for other people.

"Book swap" is located on the bench in laundry.